

DFE 400

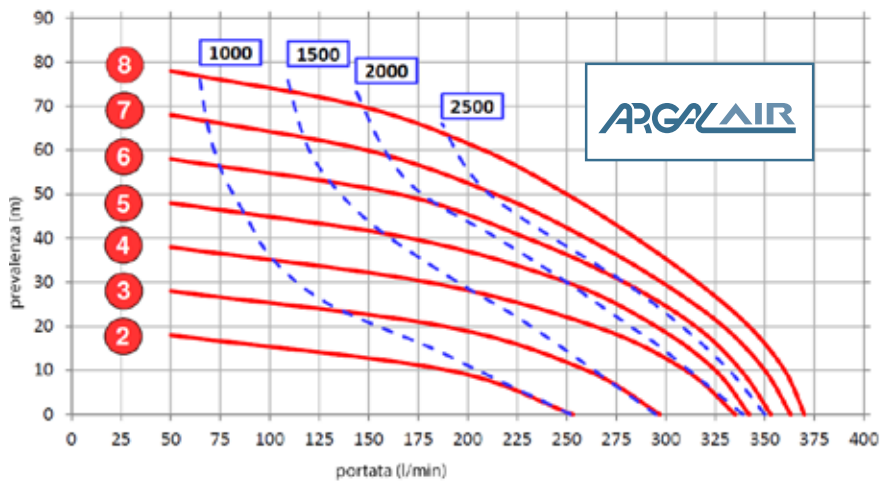

bar Air Pressure main supply **NI/min** Air consumption

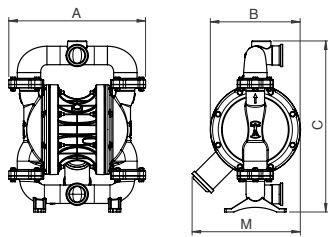

DIMENSIONS (mm)	
AISI 316L	A 400 B 263 C 501 M 317

TECHNICAL DATA	
Fluid connections	• Tri-Clamp 2"
Air connection	1/2" BSP • NPT*
Max flow rate	370 l/m'
Max air pressure	8 bar
Displacement per cycle	1.340

COMPOSITION	
Wetted parts	• AISI 316L Polished
Diaphragms	• NBR+PTFE
Valve Balls	• PTFE • AISI 316
Valve Seats	• AISI 316 • UPPE
Gaskets	• PTFE

Connections scheme page 15

* Optional

DFE 650

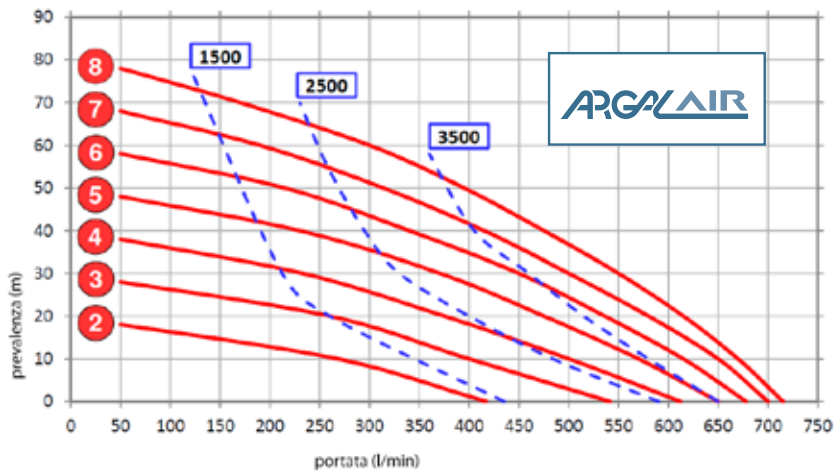

bar Air Pressure main supply **NI/min** Air consumption

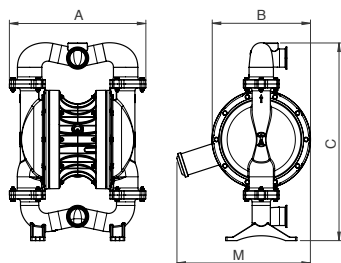

DIMENSIONS (mm)	
AISI 316L	A 479 B 345 C 695 M 381

TECHNICAL DATA	
Fluid connections	• Tri-Clamp 2 1/2" • BSP*
Air connection	3/4" BSP • NPT*
Max flow rate	715 l/m'
Max air pressure	8 bar
Displacement per cycle	3.820

COMPOSITION	
Wetted parts	• AISI 316L Polished
Diaphragms	• KEYFLEX+PTFE
Valve Balls	• PTFE • AISI 316
Valve Seats	• AISI 316 • UPPE
Gaskets	• PTFE

Connections scheme page 15

* Optional